



H.L. COSHATT COMPANY, INC.

www.hlcoshatt.com

1.800.553.2730



Pharmacy Fixtures

Design Specialist

Professional Installation

LONG TERM CARE
PHARMACY

H.L. COSHATT COMPANY, INC.

Our Company

HL Coshatt Company, Inc. (HLCC) is a specialized Healthcare Pharmacy fixture, shelving, furniture, and equipment firm. We are strongly committed to providing quality products and services to our customers, including turn-key packages from in-house design, CADD specification, project management, warehousing, and installation, for a complete offering of services to our clients.



HLCC is one of the largest Stocking Distributor of Lozier fixtures, strategically located near Lozier production facilities in Alabama with access to Lozier's network of more than 2.41 million square feet of production capacity.

Founded in 1972 by Henry Coshatt, we've built our reputation on establishing strong relationships with quality clients, superior suppliers and excellent service providers. When you work with us, you access a wealth of experience and a variety of products.

Thank you for your interest in our company.

H.L. COSHATT COMPANY, INC.

Our Products & Services

Products:

- Fixtures, Shelving, Storage and Filing, Furniture & Equipment, and our own Medi.Module

Services:

- Sales and Project Management
 - Experienced professionals dedicated to serving your needs
 - Our philosophy is to understand the needs of our customers, and respond to them with high value, innovative solutions in a prompt, experienced, and enthusiastic manner
- Design
 - Our designers are professional, knowledgeable, and dedicated to seeking the best solution for each project
 - Work with architects, contractors and other trade professionals
 - Utilize CADD and manufacturers' products and material specifications
 - Space plans, 3-D layouts, itemized equipment lists, detailed pricing proposals
 - Finish selection and custom signage
- Installation
 - Our installation specialists deliver, unload, and assemble all products on your schedule
 - Experienced professionals that have served hundreds of clients from coast to coast, and are ready to support your exact requirements





PRODUCTS

medi module
medical modular workstations & accessories

Medi.Module:

Reconfigurable modular fixtures developed by H.L. Coshatt

- Utilizes a base structure manufactured by Lozier
- Utilizes 3 different woodworking specializations:
 1. Automated standard laminate panels
 2. Solid Surface/ Corian and Corian Equivalents
 3. Custom Woodwork
- Accepts other fixtures within its structure such as:
 - Automation: Automed, TCGRX, Dosis
 - Narcotics Cabinets
 - Sinks with eyewashes, etc.
- Medi.Module configurations module:
 - Pass-Thru
 - Wall with or without backs
 - Various heights and counters
 - Call center workstations
 - Filing counters





PRODUCTS

medi module
medical modular workstations & accessories





PRODUCTS

medi module
medical modular workstations & accessories





PRODUCTS

medi module
medical modular workstations & accessories





PRODUCTS

Other Pharmacy Products:

- IV Supply Units
- Wire Shelving & Carts
- Stock Room Shelving
- Equipment Reps for Hoods and Refrigerators

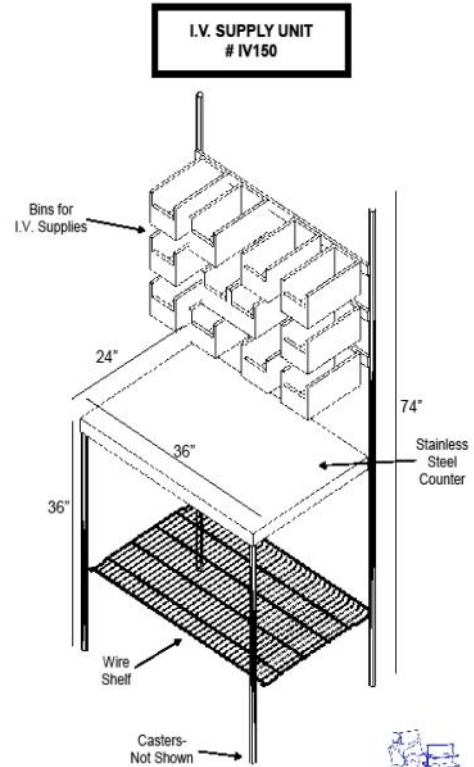



PRODUCTS

Office/Administration/Order Entry

- Systems Furniture,
Workstations, Cubicles
- Office Desks, Credenzas,
Hutches
- Waiting Rooms
- Conference Rooms &
Training Rooms
- Breakrooms
- Lockers



Virtually
Every
Fixture
In The
Pharmacy





Typical Approach to a Project

- **Design**

- 3 Typical Starting Points:

- 1. Start with CADD of Building (new or existing)

- 2. Start from scratch - We measure building and create a floor plan in CADD

- 3. New Building - We design the Pharmacy/workflow to be used to give to the architect to use to design the building

- During the design phase we coordinate with you, the architect, builder, facility owner, and subcontractor trades

- including electric, data, plumbing and security system

- Confirm final design for budgeting/quoting

- **Order**

- Typically receive 50% down with order and balance on completion

- **Installation**

- Professional experienced installers meet the truck and unload

- Typically takes 1 to 5 days to install

- Coordinate with builders and trades

- **Archive Drawings & Fixture Data**

- Future remodeling

- Future relocations



Example Drawings

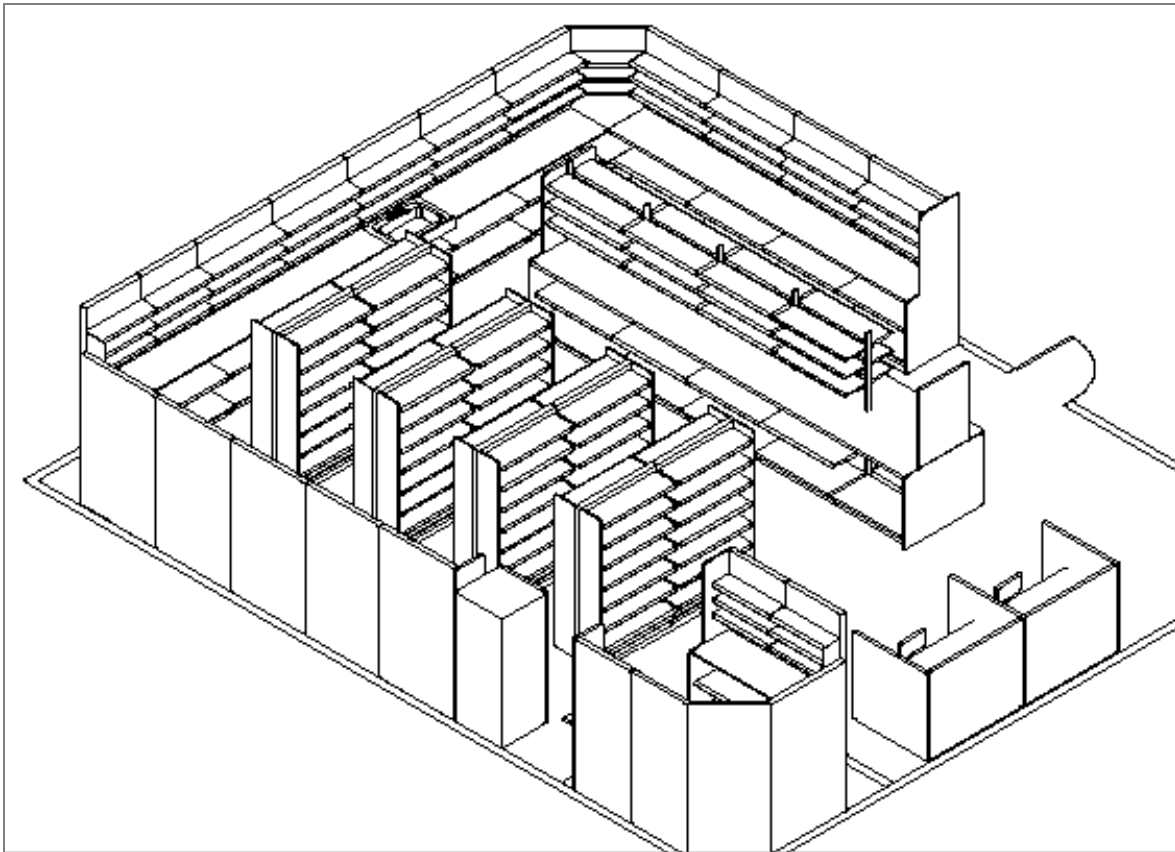
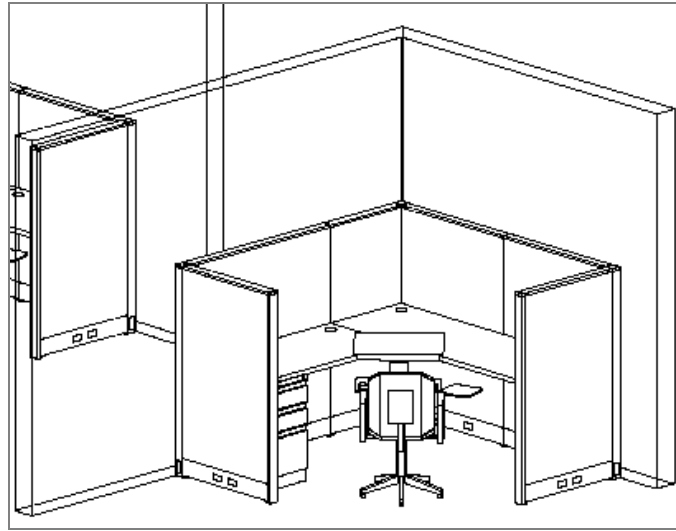
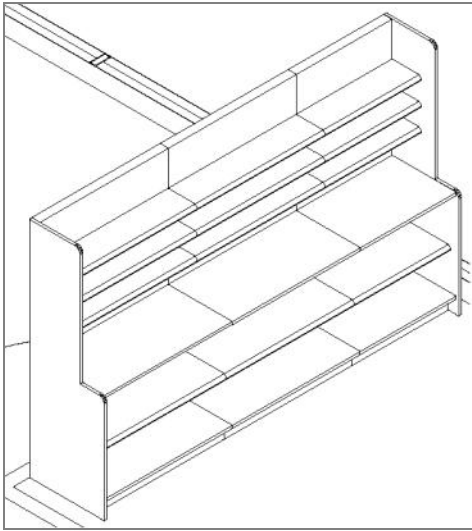



Shipping & Office Address:

8315 1st Avenue North

Suite C

Birmingham, AL 35206

Mailing Address:

P.O. Box 610759

Birmingham, AL 35261

Phone:

1.800.553.2730

205.833.2446

Fax:

205.833.6659

Email:

salesteam@hlcoshatt.com